



MATRIX ESTIMATING

"Professional Accurate Quotations"

Project: 369 Cedar Place
 Company: Power Hammer Builders
 Date: 28/02/2023
 Revision: 23131-0A



MATRIX ESTIMATING

Description	Qty	Unit Rate	Total - Ex GST
Timber Handrail - Stair Lv 10-11			
Supply and manufacture materials - 43mmD Blackbutt			
Handrail Posts	4.00 qty	\$500.00	\$ 2,000.00
Handrail Supply	23.74 Lm	\$210.61	\$ 5,000.00
Handrail 90 deg Bend	6.00 qty	\$166.67	\$ 1,000.00
Installation labour			
Labour - installation of posts	4.00 qty	\$125.00	\$ 500.00
Labour - installation of handrail	23.74 Lm	\$84.25	\$ 2,000.00
Labour - installation of handrail brackets	27.00 qty	\$37.04	\$ 1,000.00
Labour - sanding and finishing	23.74 Lm	\$29.49	\$ 700.00
			Subtotal: \$ 12,200.00
Timber Handrail - Stair Lv 11-12			
Supply and manufacture materials - 43mmD Blackbutt			
Handrail Posts	4.00 qty	\$500.00	\$ 2,000.00
Handrail Supply	20.74 Lm	\$192.86	\$ 4,000.00
Handrail 90 deg Bend	4.00 qty	\$175.00	\$ 700.00
Installation labour			
Labour - installation of posts	4.00 qty	\$125.00	\$ 500.00
Labour - installation of handrail	20.74 Lm	\$96.43	\$ 2,000.00
Labour - installation of handrail brackets	28.00 qty	\$35.71	\$ 1,000.00
Labour - sanding and finishing	20.74 Lm	\$28.93	\$ 600.00
			Subtotal: \$ 10,800.00
Cladding to Stringer - Stair Lv 10-11			
Install Only - Materials by AM			
Fixing materials	19.23 Lm	\$52.00	\$ 1,000.00
Installation labour			
Cladding Installation	19.23 Lm	\$520.02	\$ 10,000.00
			Subtotal: \$ 11,000.00
Cladding to Stringer - Stair Lv 11-12			
Install Only - Materials by AM			
Fixing materials	15.98 Lm	\$62.58	\$ 1,000.00
Installation labour			
Cladding Installation	15.98 Lm	\$500.63	\$ 8,000.00
			Subtotal: \$ 9,000.00
Void Cladding - Stair Lv 11-12			
Install Only - Materials by AM			
Plywood to cladding and return to ceiling	15.26 m2	\$65.53	\$ 1,000.00
Framing materials and split battens	21.01 Lm	\$190.39	\$ 4,000.00
Shop drawings	1.00 qty	\$1,000.00	\$ 1,000.00
Installation labour			
Manufacturing Labour - Plywood	21.01 Lm	\$285.58	\$ 6,000.00
Framing labour	21.01 Lm	\$380.77	\$ 8,000.00
Cladding Installation	21.01 Lm	\$571.16	\$ 12,000.00
			Subtotal: \$ 32,000.00
Preliminaries			
Allowance for site measure	1.00 qty	\$800.00	\$ 800.00

Shop drawings	1.00 qty	\$700.00	\$	700.00
Allowance for deliveries	2.00 qty	\$50.00	\$	100.00
Allowance for protection of handrail	44.48 Lm	\$17.99	\$	800.00
Allowance for protection of cladding	56.22 Lm	\$14.23	\$	800.00
Allowance for rubbish removal	1.00 qty	\$300.00	\$	300.00
Allowance for consumables	100.70 qty	\$9.93	\$	1,000.00
Material handling and setup	100.70 qty	\$9.93	\$	1,000.00
Final Clean	1.00 qty	\$300.00	\$	300.00
			Subtotal:	\$ 5,800.00
Commercial Discount	1.00 qty	-\$11,500.00	-\$	11,500.00
			Price excluding GST	\$ 69,300.00
			GST @ 10%	\$ 6,930.00
			Price including GST	\$ 76,230.00
<u>No Allowances</u>				
Aluminum cladding - Materials by AM				
Make good or grinding of patch fittings on glass				
Fixing lugs to steel beams - by Active Metal				
Cladding to void edge on Level 10-11				
Silicone jointing to aluminium cladding				
Treads & Risers				
Nosings				
Tactiles				
Soffit works				
Glass works				
Balustrade works				
Structural steel works				
Scaffolding				
Expansion joints				
Shop drawings				
Drilling holes in steel				
X-raying of floor slabs				
Core drilling				
<u>Please note the following:</u>				
All works have been allowed to be carried during the hours of 7.00am and 4pm, Monday to Saturday.				
If Power Hammer Builders hits more than 20% of Reo when drilling concrete - additional charges can apply				
This quotation holds firm for thirty (30) days after which time it may become subject to review.				
This quotation is subject to mutually agreed terms of contract and payment.				
Client to ensure that each area is fully cleared and ready for us to carry out our work uninterrupted				
The above price is based on what could have been reasonably expected to be known at the time of pricing. If factors arise, throughout construction, that were reasonably unknown, the above quotation may become subject to review.				

Legend

- 00 - Stairs\02 - Cladding/Stair Lv 11-12
- CL 02 - Void Cladding - 1m 14.09 m
- CL 02a - Cladding Type 1 - m2 6.92 m2

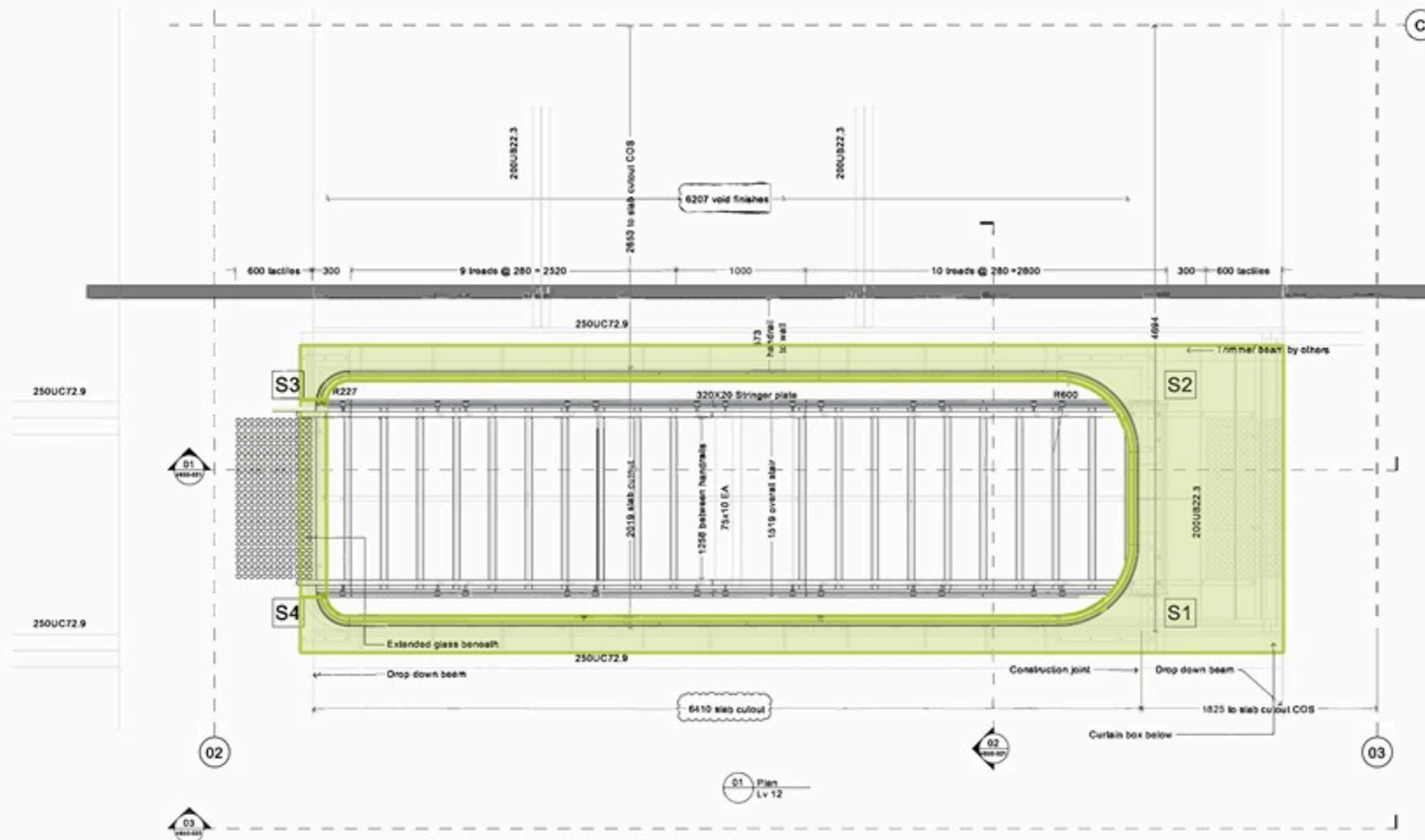

01 Plan Lv 12

ISSUED FOR APPROVAL

REV	Date	Description
01	26-09-2022	Issued for Tender
02	07-10-2022	Issued for Tender
03	17-11-2022	Issued for Approval
04	21-12-2022	Issued for Approval
05	17-01-2023	Issued for Approval

All dimensions to be verified on site prior to commencing work.
All dimensions in millimetres. Do not scale. If in doubt, ask.
All Rights Reserved. COPYRIGHT of Active Metal Pty Ltd

Date	17-01-2023	Drawn	JM	Checked/Approved	CW
Rev. No.	4650	Drawing Number	4650-012-05	Sheet	05



MATRIX ESTIMATING

Legend

- 00 - Stairs\02 - Cladding/Stair Lv 11-12
- CL. 02 - Void Cladding - 1m 14.09 m
- CL. 02a - Cladding Type 1 - m2 6.92 m2

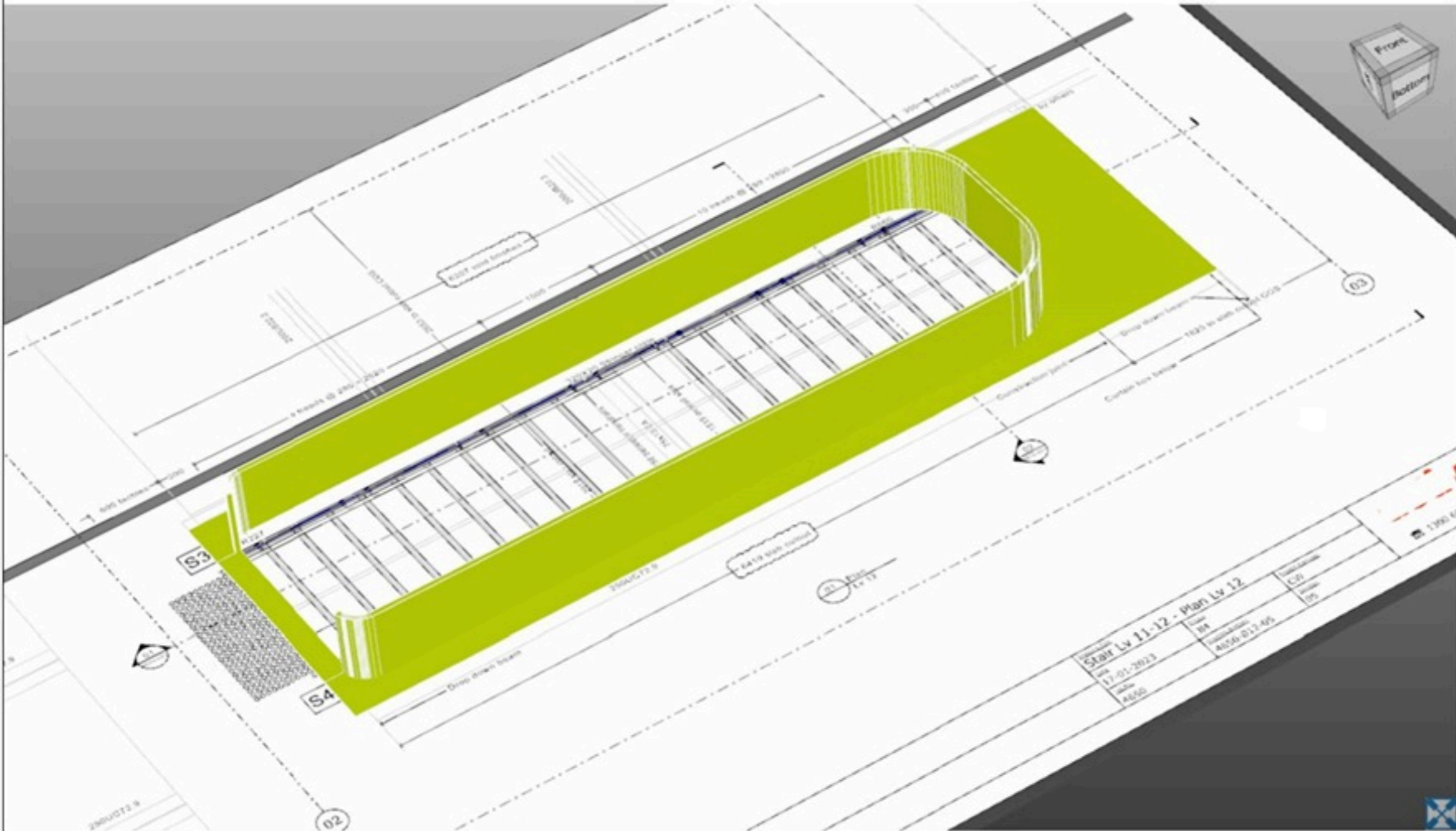

Stair Lv 11-12 - Plan Lv 12	
Date	17-01-2023
Author	BA
Project	4056 013-05
Scale	1/5
Sheet	02
Total	1/5



MATRIX ESTIMATING

Legend

00 - Stairs\01 - Handrails/Stair Lv 11-12	
HR 04 - 43mm Diameter x 1	16.74 m
HR 06 - Timber posts x 1	4.00 no
HR 10 - Handrail brackets x 1	28.00 no
HR 14 - 90 Degree Bends x 1	4.00 no
00 - Stairs\02 - Cladding/Stair Lv 11-12	
CL 03 - Cladding to Stringer - 1m	15.98 m
00 - Stairs\04 - Misc	
MI 04 - Reference Only - Stair Lv 11-12	1.00 no

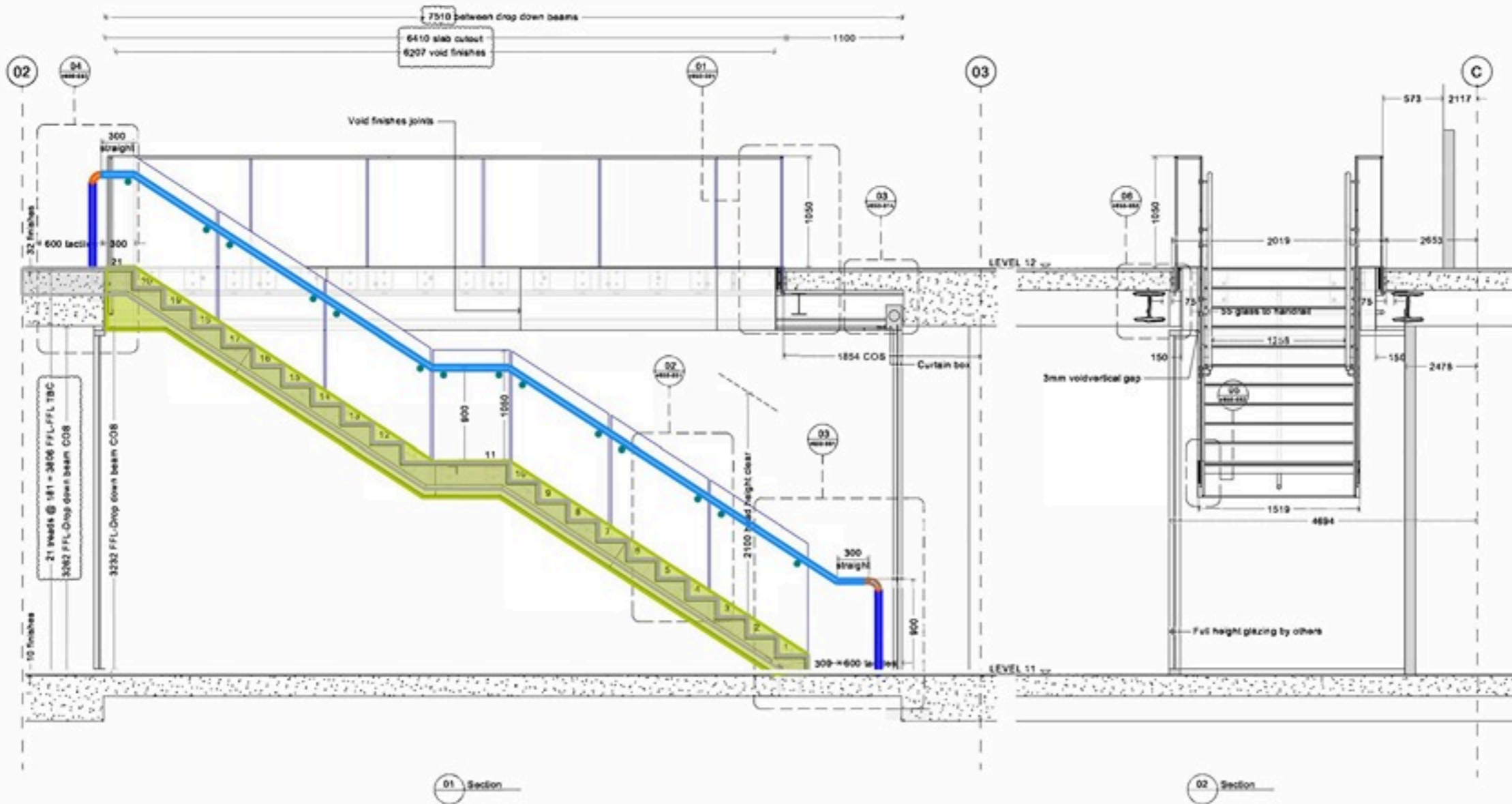

01 Section

02 Section

ISSUED FOR APPROVAL

REV	Date	Description
01	28-01-2023	Issued for Tender
02	07-09-2023	Issued for Tender
03	17-01-2023	Issued for Approval
04	21-07-2023	Issued for Approval
05	17-01-2023	Issued for Approval

All dimensions to be verified on site prior to commencing work.
All dimensions in millimetres. Do not scale. If in doubt, ask.
All Rights Reserved. COPYRIGHT of Active Metal Pty Ltd

REV	DATE	BY	CHKD
17-01-2023		JM	CW
4650	4650-021-05		05



MATRIX ESTIMATING

Legend

00 - Stairs\01 - Handrails/Stair Lv 11-12	
HR 04 - 43mm Diameter x 1	16.74 m
HR 06 - Timber posts x 1	4.00 no
HR 10 - Handrail brackets x 1	28.00 no
HR 14 - 90 Degree Bends x 1	4.00 no
00 - Stairs\02 - Cladding/Stair Lv 11-12	
CL 03 - Cladding to Stringer - 1m	15.98 m
00 - Stairs\04 - Misc	
MI 04 - Reference Only - Stair Lv 11-12	1.00 no

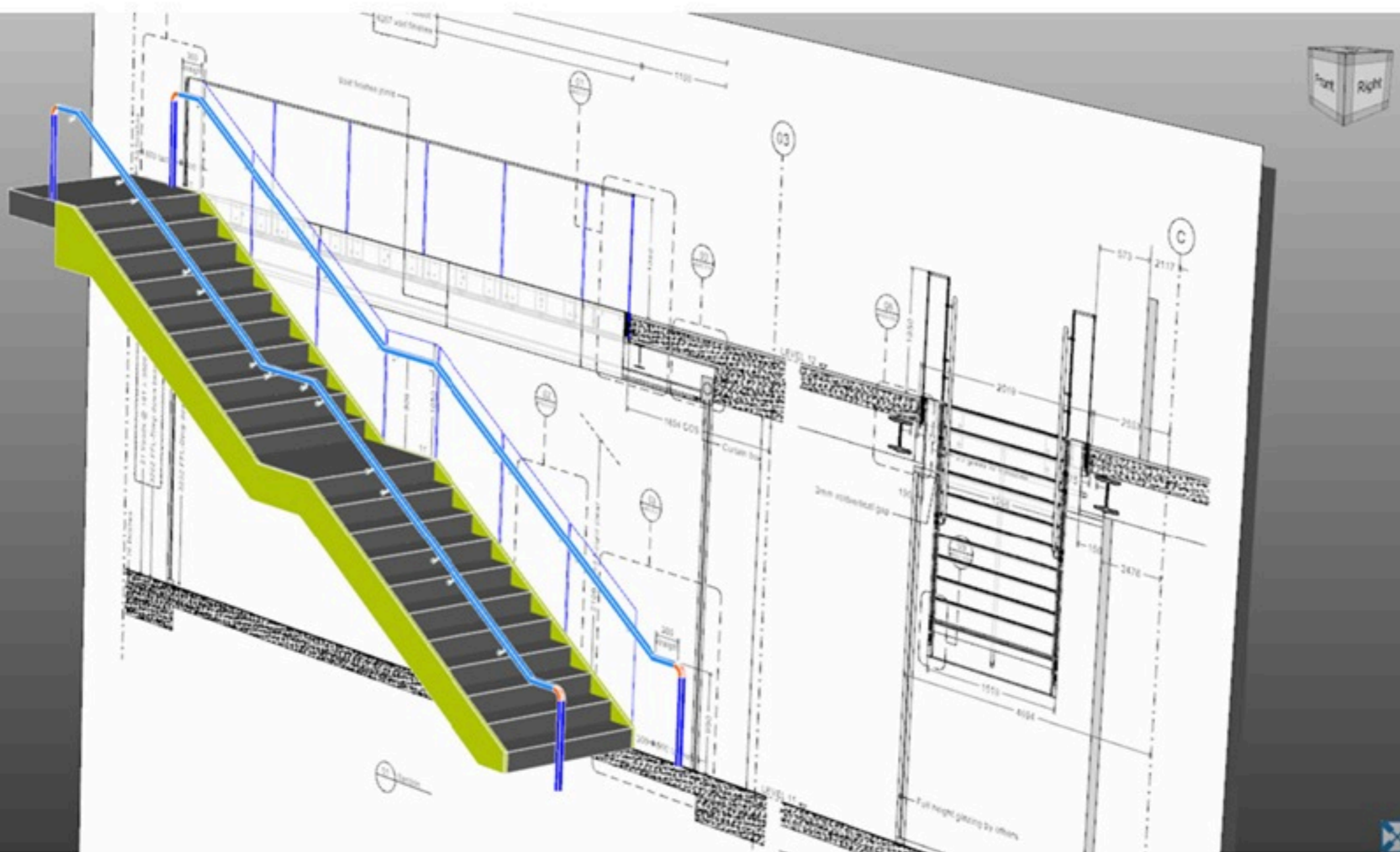

MATRIX ESTIMATING

Legend

00 - Stairs\01 - Handrails/Stair Lv 10-11	
HR 03 - 43mm Diameter x 1	18.09 m
HR 03a - 43mm Diameter x 1	1.65 m
HR 05 - Timber posts x 1	4.00 no
HR 09 - Handrail brackets x 1	27.00 no
HR 13 - 90 Degree Bends x 1	6.00 no
00 - Stairs\02 - Cladding/Stair Lv 10-11	
CL 01 - Cladding to Stringer - 1m	17.40 m
CL 01a - Cladding to Stringer - 1m	1.83 m
00 - Stairs\04 - Misc	
MI 03 - Reference Only - Stair Lv 10-11	1.00 no

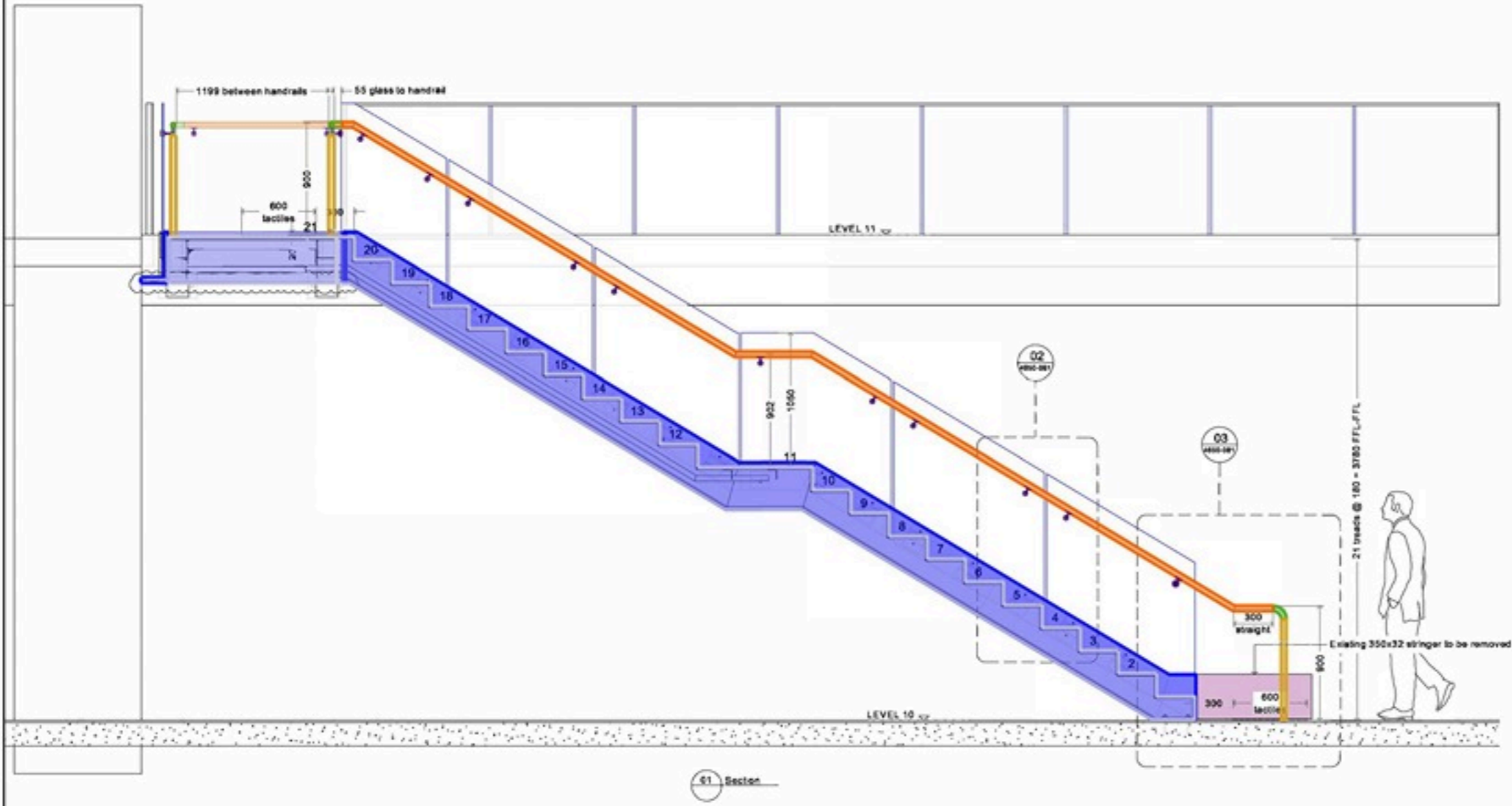

01 Section

ISSUED FOR APPROVAL	REV	Date	Description	<table border="1"> <tr> <td>REV</td> <td>DATE</td> <td>REVISED BY</td> </tr> <tr> <td>17</td> <td>JM</td> <td>CW</td> </tr> <tr> <td>4650</td> <td>4650-071-05</td> <td>05</td> </tr> </table>	REV	DATE	REVISED BY	17	JM	CW	4650	4650-071-05	05
	REV	DATE	REVISED BY										
	17	JM	CW										
	4650	4650-071-05	05										
	01	28-09-2023	Issued for Tender										
02	07-10-2023	Issued for Tender											
03	17-11-2023	Issued for Approval											
04	21-12-2023	Issued for Approval											
05	17-01-2024	Issued for Approval											

All dimensions to be verified on site prior to commencing work.
 All dimensions in millimetres. Do not scale. If in doubt, ask.
 All Rights Reserved. COPYRIGHT of Active Metal Pty Ltd



MATRIX ESTIMATING

Legend

00 - Stairs\01 - Handrails/Stair Lv 10-11	
HR 03 - 43mm Diameter x 1	18.09 m
HR 03a - 43mm Diameter x 1	1.65 m
HR 05 - Timber posts x 1	4.00 no
HR 09 - Handrail brackets x 1	27.00 no
HR 13 - 90 Degree Bends x 1	6.00 no
00 - Stairs\02 - Cladding/Stair Lv 10-11	
CL 01 - Cladding to Stringer - 1m	17.40 m
CL 01a - Cladding to Stringer - 1m	1.83 m
00 - Stairs\04 - Misc	
MI 03 - Reference Only - Stair Lv 10-11	1.00 no

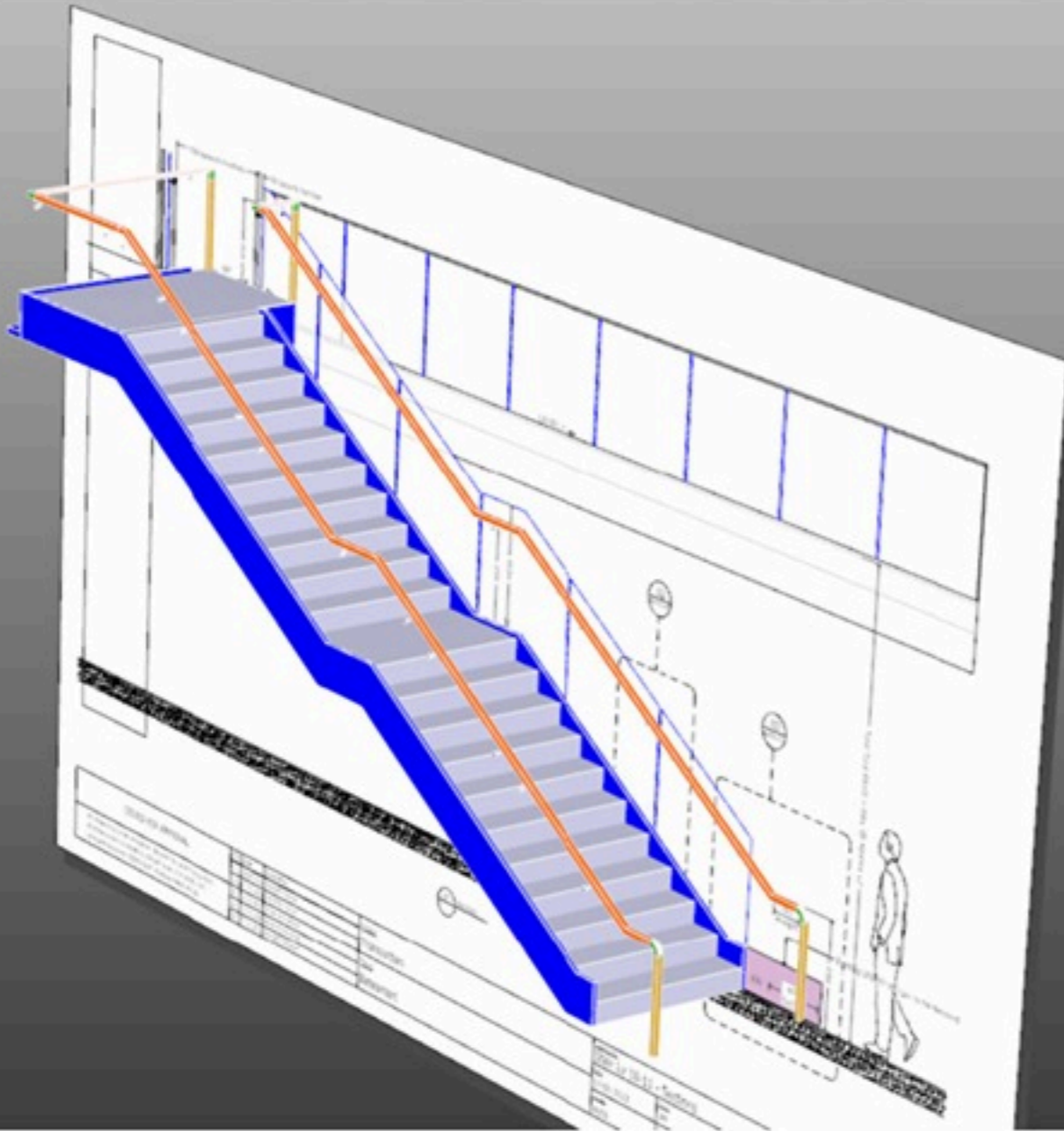

MATRIX ESTIMATING